

BED59 series explosion-proof maintenance free energy-saving LED lamp

Scope of application

1. Used in Zone 1 and Zone 2; Zone 21 and Zone 22; IIA, IIB, IIC;
2. Temperature group: T1~T6;
3. Suitable for energy saving renovation projects and places where maintenance and replacement are difficult;
4. Widely used in petroleum exploitation, refining, chemical industry, military industry, textile, food processing and offshore oil platform, tanker and other places of lighting.



Feature of product

1. The radiator is designed to be made of special cast aluminum alloy by die-casting, and its surface is sprayed with high voltage static electricity;
2. Exposed stainless steel fasteners with high corrosion resistance;
3. The flame-proof thread flame-proof joint surface of the rabbit has a pure flame-proof structure and more reliable explosion-proof performance;
4. Standard three box separation structure design, modular installation and combination. Effectively reduce temperature rise to ensure long life of lamps;
5. Multi point lighting, high light utilization, uniform illumination without glare;
6. High strength material, transparent tempered glass, with strong impact resistance, heat resistance and high light transmittance;
7. The constant current power supply has wide voltage input and constant current output, and has the protection functions of shunt, surge prevention, overcurrent, open circuit, open circuit, high temperature, anti electromagnetic interference, etc;
8. Power factor $\cos \phi \geq 0.95$;
9. Steel pipe or cable wiring.

Featured display



Well-known brand chips, reasonable arrangement, unidirectional light emission, uniform and soft light, light efficiency $> 120\text{lm/W}$, high color rendering $Ra > 70$, long service life, green environmental protection, color temperature 3000K~5700K.

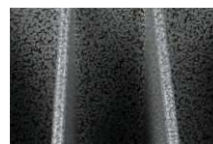

The natural ventilation convection heat dissipation technology uses air flow to dissipate to the surface of the heat sink of the lamp through the heat dissipation channel and heat flow channel, effectively dissipating the heat of the LED light source and ensuring the long-life operation of the LED explosion-proof lamp.

Technical parameter

Model	Explosion-proof mark	light source	Lamp type	Power (W)	Luminous flux (Lm)	Color temperature (k)	Weight (kg)
BED59-□	Ex db IIC T6 Gb Ex tb IIIC T80°C Db	LED	I	10~30	1200~3600	3000~5700	2.6
			II	40~60	4800~7200		3.4
			III	80~100	9600~12000		4.3
			IV	120~150	14000~18000		6.5
			V	160~200	19200~24000		7.1

Rated voltage/frequency	Inlet thread	Cable outer diameter	Protection class	Corrosion class
220V/50Hz	G3/4	$\Phi 10 \sim \Phi 14\text{mm}$	IP66	WF2

Light distribution curve

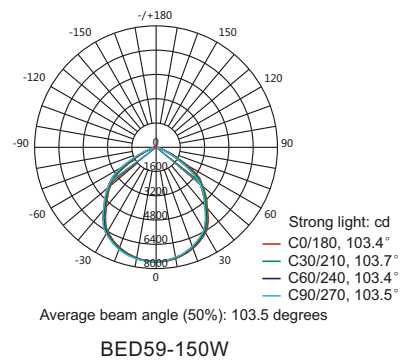
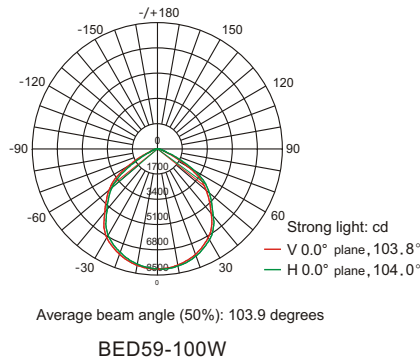
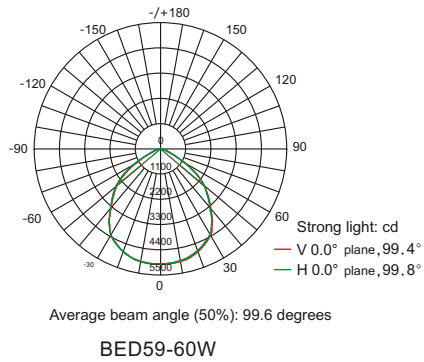

Appearance and installation example

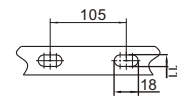
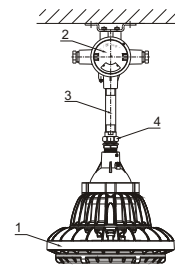
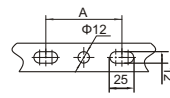
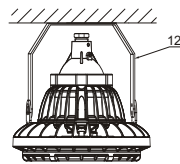
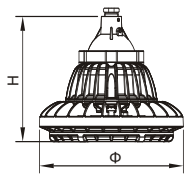

z: Conventional bracket type

Bracket installation dimension

g: Suspender type

Installation dimension of ceiling box

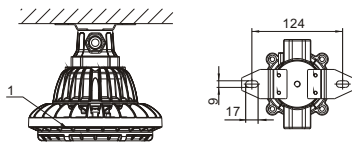

x: Ceiling mounted

Ceiling mounting dimensions

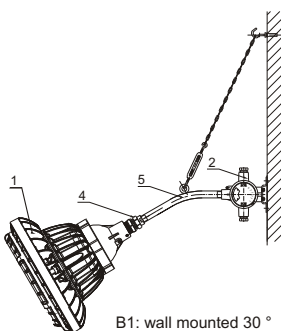

B1: wall mounted 30°

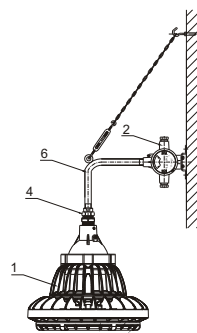

B2: wall mounted 30°

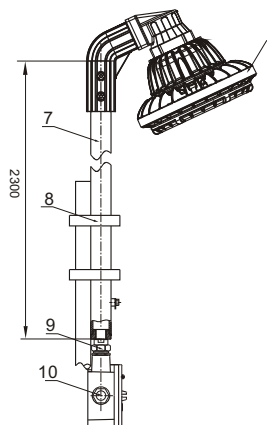

h: Guardrail type

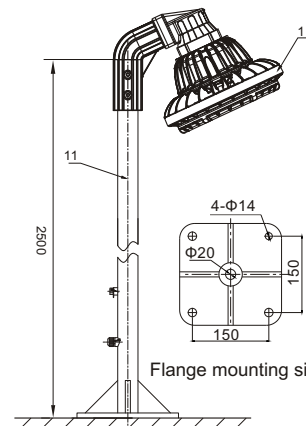

f: Flange type

Number	Specifications	Type	Power Range (W)	Φ(mm)	H(mm)	A(mm)
1	BED59-30W	I	10-30	209	224	85
2	BED59-60W	II	40-60	236	224	85
3	BED59-100W	III	80-100	252	219	85
4	BED59-150W	IV	120-150	306	240	85
5	BED59-200W	V	160-200	352	250	85